

# PROJECT OF THE MONTH | LaLaport BBCC, Kuala Lumpur [MY]

03  
22



Photo: © KL Interior Photography, Ryan Chin



CEILING  
LIGHTING  
AMBIENCE

durlum.com

# PROJECT OF THE MONTH | LaLaport BBCC Kuala Lumpur [MY]

03  
22

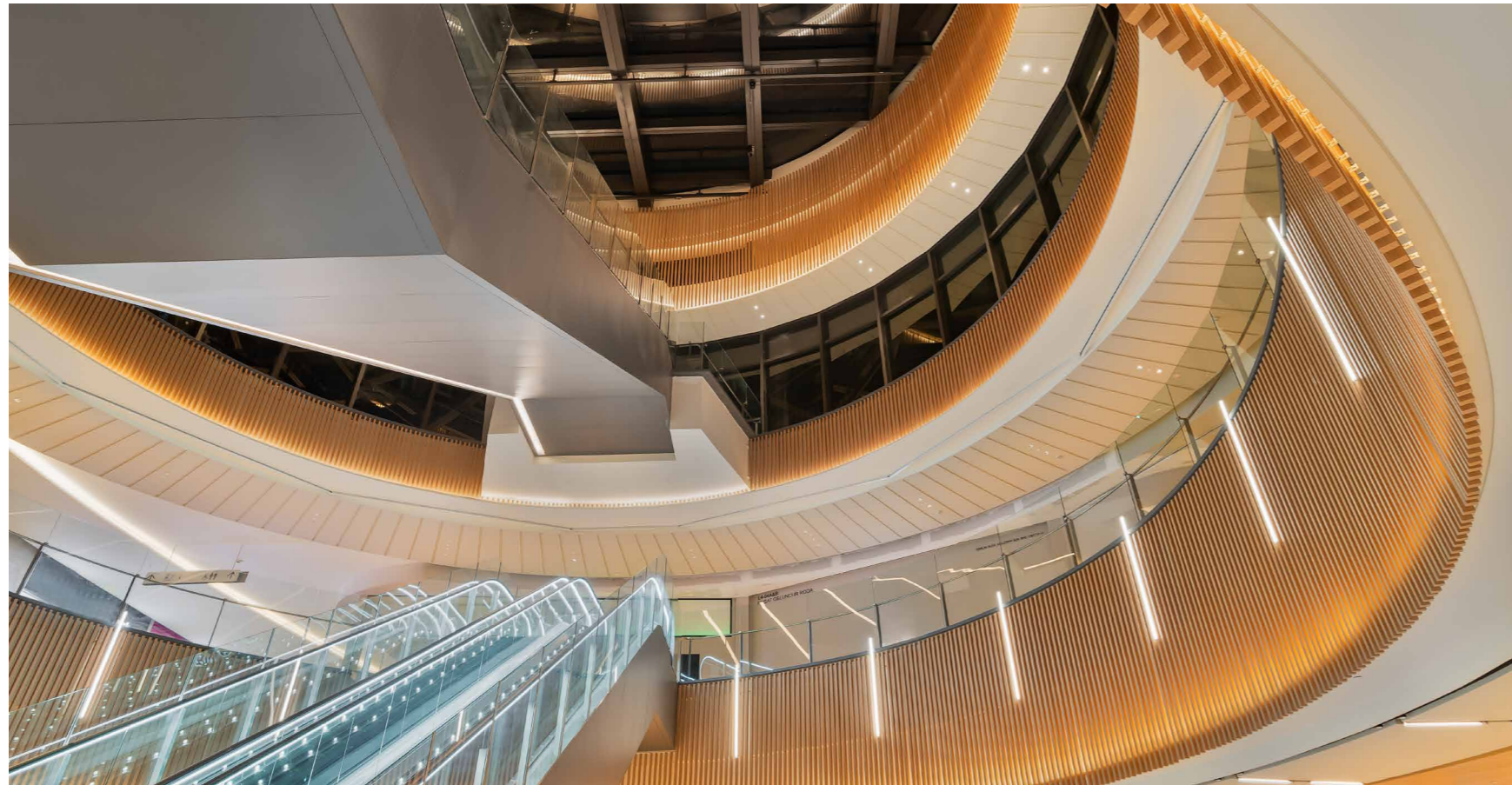

**PROJECT** LaLaport Bukit Bintang City Centre, Kuala Lumpur [MY]

**OPENING** January 2022

**ARCHITECTS** GDP Architects Sdn Bhd

**PRODUCT** **Straight and curved POLYLAM vertical baffles:**

**Ceiling:** 1.5mm thickness of aluminium; dimensions: 150mm x 25mm [H x W]; powder-coated, wood look

**Wall cladding:** 1 mm thickness of aluminium for the straight and 2 mm aluminium for the curved baffles; dimensions: 75 mm x 50mm [H x W] and 60mm x 40mm; powder-coated with a wood look

Right in the heart of the extensive urban development project of Bukit Bintang City Centre [BBCC] in Kuala Lumpur, Tokyo-based real estate company Mitsui Fudosan has opened LaLaport BBCC, its first shopping centre in South-East Asia – and its second outside Japan.

With its strategic location in the tourism magnet of the 'Golden Triangle', 400 or so shops selling Japanese, local and international brands occupy a retail floor area of roughly 82,600m<sup>2</sup>, catering for visitors from right around the world.

The architects applied the Modern Simplicity design concept throughout the building, enhanced with Japanese elements that are inspired by the warmth of the natural world. Our POLYLAM vertical baffle system is a central element, and its special powder coating resembles real wood. Curved baffles on the guardrails define gentle highlights and harmonise perfectly with the straight ceiling and wall louvres, arranged in a variety of directions. This linear clarity creates spaces for interaction and relaxation, promoting the new lifestyle-based world of experience that seeks to set trends in Malaysia.