

UNTERKONSTRUKTION

POLYLAM dur-COOLTEC

Sekundärprofil | Secondary profile | Profilé secondaire

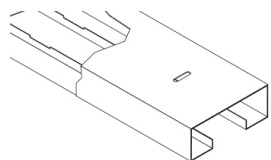

POLY-KS-DHK000

Doppelhakenprofil | Double hook-on profile | Profil à double crochet

Länge in Abhängigkeit von Modul | Length depending on modul | Longueur en fonction du module

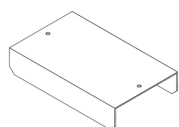

POLY-KS-V-DHK

Längsverbinder für Doppelhakenprofil | Double hook-on profile connector | Connecteur de profil à double accrochage



POLY-SIC-00

POLYLAM Anhebesicherung | Baffle security clip | Pince de sécurité à baffle



POLY-KS-KHK00

Abklapphaken | Hinge-down hook | Crochet à charnière



POLY-KS-SHK00

Schiebehaken | Sliding hook | Crochet coulissant

Primärprofil | Primary profile | Profilé primaire

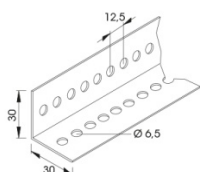

U 1040

Rostwinkel mit Regellochung | L-shaped primary carrier with regular perforation | Cornière à perforation régulière

L= 4000 mm

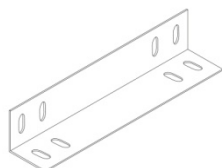

U 1041

Rostwinkelverbinder | L-shaped primary carrier connector | Connecteur pour cornière perforée

L= 150 mm

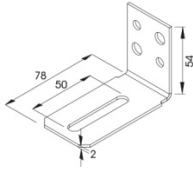

U 1042

Wandanker | Wall bracket | Dispositif d'ancrage au mur

Stahl verzinkt | Steel galvanized | Acier galvanisée

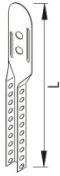

U 1300

Noniusoberteil | Nonius upper part | Élément de suspension Nonius sup.

L (min): 150 mm, L (max): 2000 mm



U 1370

Noniusunterteil | Nonius lower part | Élément de suspension Nonius inf.

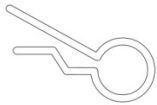

U 1372

Nonius-Sicherungsstift | Nonius connector pin | Groupille de sécurité Nonius

Magnet | Magnet | Aimant

Keine Randprofile | No Wall connection Profiles | Pas de profil de raccordement au mur