

# UNTERKONSTRUKTION

## FS4.2 RHOMBOS

### Unterkonstruktion | Substructure | Ossature

---

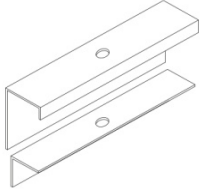

#### U 401

Verbinder für Z-Profil | Carrier connector | Connecteur pour profilé en Z

L = 100 mm

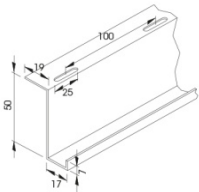

#### U 1005 A

Z-Auflageprofil | Z-shaped carrier | Profilé de support en Z

L = 4000 mm

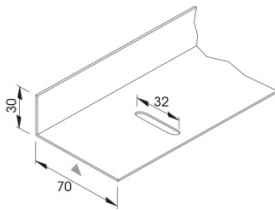

#### U 1032

Wandwinkel | Perimeter trim | Cornière murale

Stahl verzinkt | Galvanized steel | Acier galvanisé: 1,5 mm

L = 3 000 mm

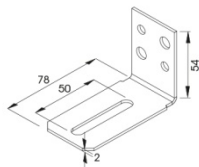

#### U 1042

Wandanker | Wall bracket | Dispositif d'ancrage au mur

Stahl verzinkt | Steel galvanized | Acier galvanisée

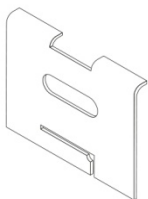

#### U 1044

Rostwinkel-Moduladapter | Module adapter for L-shaped primary carrier |  
Adaptateur modulaire pour cornière perforée



#### U 1044 FK

Halte- und Fixierungsklammer | Retaining and fixation clip | Pince de maintien  
et de fixation

# UNTERKONSTRUKTION

## Optionale Unterkonstruktion | Optional substructure | Ossature en option

---

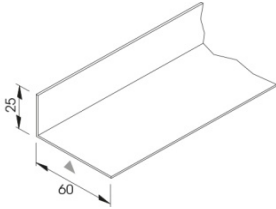

### AW 2560

Abdeckwinkel | Perimeter trim | Cornière de finition

Stahl verzinkt | Galvanised steel | Acier galvanisé: 0,6 mm  
L = 4000 mm, Schwarz | Black | Noir

---

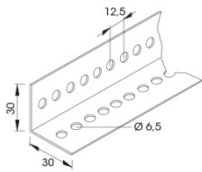

### U 1040

Rostwinkel mit Regellochung | L-shaped primary carrier with regular perforation  
| Cornière à perforation régulière

L = 4000 mm

---

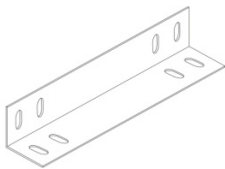

### U 1041

Rostwinkelverbinder | L-shaped primary carrier connector | Connecteur pour  
cornière perforée

L = 150 mm

---

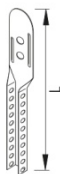

### U 1300

Noniusoberteil | Nonius upper part | Élément de suspension Nonius sup.

L (min): 150 mm, L (max): 2000 mm

---



### U 1370

Noniusunterteil | Nonius lower part | Élément de suspension Nonius inf.

---



### U 1372

Nonius-Sicherungsstift | Nonius connector pin | Groupille de sécurité Nonius

---